

Installation Manual

Model #: ST-5G

Cotytech

www.cotytech.com

888-891-9321

PARTS BREAKDOWN

- ① Desktop ② Round base ③ Mounting plate ④ Gas spring ⑤ Screw=3 ⑥ Screw=4 ⑦ Allen key



ASSEMBLY STEPS

- A** Fasten the round base (2) into the bottom of gas spring (4) with 3 screws (5).
(Tool: Allen key (7) No.4)

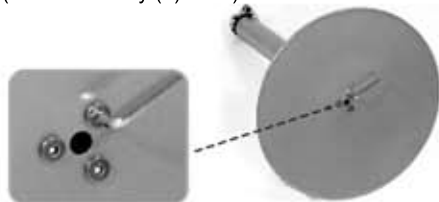

- B** Place the desk surface (1) face down onto the floor, then fasten together with the mounting plate (3) with 4 screw (6).

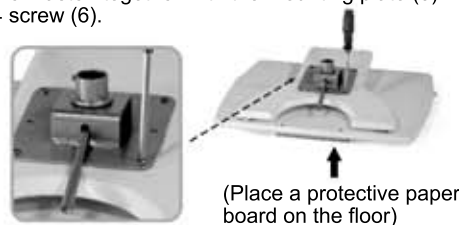

- C** Install the semi-finished part (from step B) into the other end of gas spring (4)
(Note assembly direction)



- D** Press down the desktop (1) by force for a closer fit with gas spring (4).



ADJUSTMENT

- A** Release the fastener of the tilting angle bar to open up the tabletop.
(Note: The tilted top must be extended to the ultimate then can be returned to flat top.)

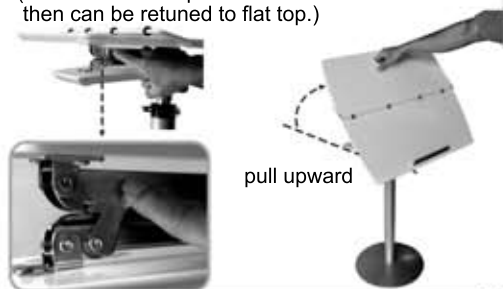

Lastly, fasten the adjustment screw under the mounting plate tightly by Allen key (7) No.3



- B** Release the locking lever for top rotation or desk height adjustment.



- C** If the locking lever is too loose, you can turn the nut for adjustment.

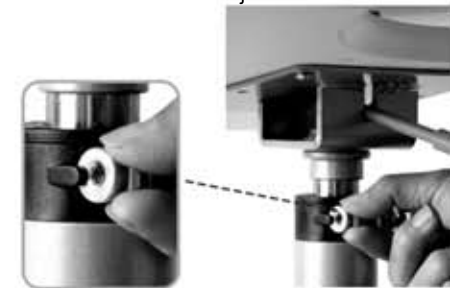

USAGE OF MONITOR SURFACE

UP



Press up the lift lever of gas spring to raise, and release to stop.

Release the locking lever of gas spring.

DOWN

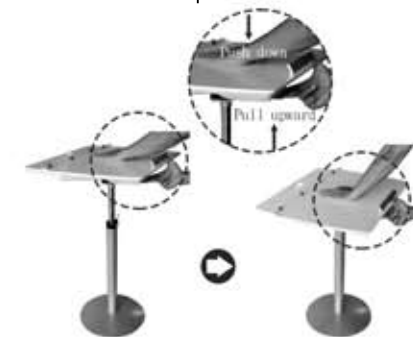

Use left (or right) hand to press up the lift lever and assisted with the other hand and body weight to press down the desktop, then the desk top can go down smoothly.

Fasten tightly the locking lever.

